

2500360.00  
ADDENDUM NO. 1

DATE: July 2, 2026

FROM: Baxter & Woodman, Inc., Consulting Engineers

TO: Planholders of record for the Work titled:

VILLAGE OF HOFFMAN ESTATES, ILLINOIS  
SHOE FACTORY ROAD WATER MAIN REHABILITATION

The Bidding Documents are amended as follows:

1. SPECIFICATIONS

A. BLR 12201, Schedule of Prices

Delete form BLR 12201, Schedule of Prices in its entirety, and insert the attached form BLR 12201, revision dated July 2, 2026, in lieu thereof.

B. Special Provisions, Section CURED-IN-PLACE PIPE (WATER MAIN).

Replace Section "WATER MAIN LINING PRODUCT", paragraph A with the following:

A. Basis of Design:

Pipe Condition	Fully deteriorated
Depth to pipe invert	6-feet
Design life (yrs)	50
Safety factor	2
Groundwater level	At surface
Ovality circumference	2%
Soil Modulus	1000 psi
Internal design pressure	125 psi

Replace Section "WATER MAIN LINING PRODUCT", paragraph E with the following:

E. Acceptable manufacturers and systems:

1. Sanexen Environmental Services, Inc. – AquaPipe System.
2. Insituform Technologies USA, Inc. – InsituMain System.
3. RS Blueline – Hammerhead Trenchless Equipment.
4. Sekisui NordiTube, Inc – Nordipipe System
5. Or approved equal.

Replace Section "TESTING", paragraph B with the following:

- B. Test watertightness by hydrostatic water testing method in ASTM F1216 after stabilization of the CIPP.
  - 1. Proposed working pressure for the water main is approximately 75 psi.
  - 2. Testing requirement is 125 psi (2.0 times the working pressure or the working pressure plus 50 psi, whichever is less) for 2 hours. Allowable leakage is 20 gallons per inch diameter per mile per day.

C. Village of Hoffman Estates Summary of Quantities

Delete the Village of Hoffman Estates Summary of Quantities in its entirety and insert the attached Village of Hoffman Estates Summary of Quantities, revision dated July 2, 2026, in lieu thereof.

2. DRAWINGS

- A. Delete SHEET NO. 5 in its entirety, and insert SHEET NO. 5, revision dated July 2, 2026, in lieu thereof.
- B. Delete SHEET NO. 6 in its entirety, and insert SHEET NO. 6, revision dated July 2, 2026, in lieu thereof.
- C. Delete SHEET NO. 7 in its entirety, and insert SHEET NO. 7, revision dated July 2, 2026, in lieu thereof.

Nothing in this Addendum shall be construed as changing other requirements of the Bidding Documents. Each Bidder shall acknowledge receipt of this Addendum where indicated in the Bid Form.

END OF ADDENDUM NO. 1



Schedule of Prices

Contractor's Name

Contractor's Address

City

State Zip Code



Local Public Agency

Section Number

Village of Hoffman Estates

NA

Route(s) (Street/Road Name)

Shoe Factory Road Water Main Rehabilitation

Schedule for Multiple Bids

Combination Letter	Section Included in Combinations	Total

Schedule for Single Bid

(For complete information covering these items, see plans and specifications.)

Item Number	Items	Unit	Quantity	Unit Price	Total
1	PRECONSTRUCTION VIDEO RECORDING	LSUM	1		
2	ABANDON EXISTING WATER MAIN AND APPURTENANCES	LSUM	1		
3	TRENCH BACKFILL - WATER MAIN	FOOT	84		
4	DUCTILE IRON WATER MAIN, OPEN CUT, 16-INCH RJT	FOOT	109		
5	CURED-IN-PLACE PIPE (WATER MAIN), 16-INCH	FOOT	1,801		
6	CONNECTION TO WATER MAIN (NON-PRESSURE), 16-INCH	EACH	2		
7	WATER VALVES, 16-INCH	EACH	2		
8	VALVE VAULTS, 5-FOOT	EACH	1		
9	VALVE VAULTS, 6-FOOT	EACH	1		
10	FIRE HYDRANTS	EACH	1		
11	FIRE HYDRANT BARREL EXTENSION	FOOT	8		
12	EXPLORATION TRENCH (SPECIAL)	FOOT	100		
13	PARKWAY RESTORATION	SQ YD	1,133		
14	HOT-MIX ASPHALT SURFACE REMOVAL AND REPLACEMENT	SQ YD	12		
15	AGGREGATE SURFACE COURSE REMOVAL AND REPLACEMENT, 8"	SQ YD	3,160		
16	DUST CONTROL WATERING	UNIT	40		
17	NON-SPECIAL WASTE DISPOSAL (IDOT ITEM 66900200)	CU YD	10		
18	SOIL DISPOSAL ANALYSIS (IDOT ITEM 66900530)	EACH	1		
19	REGULATED SUBSTANCES PRE-CONSTRUCTION PLAN (IDOT ITEM 66901001)	LSUM	1		
20	REGULATED SUBSTANCES FINAL CONSTRUCTION REPORT (IDOT ITEM 66901003)	LSUM	1		
21	REGULATED SUBSTANCES MONITORING (IDOT ITEM 66901006)	CAL DAY	5		

22	FILTER ASSEMBLY SUPPLY AND INSTALLATION	EACH	3		
23	PERIMETER EROSION BARRIER INSTALLATION AND MAINTENANCE	FOOT	2,100		
24	TREE ROOT PRUNING	EACH	5		
25	TREE PRUNING (1 TO 10 INCH DIAMETER)	EACH	2		
26	TREE PRUNING (OVER 10 INCH DIAMETER)	EACH	2		
27	TREE TRUNK PROTECTION	EACH	5		
28	TEMPORARY FENCE	FOOT	45		
Bidder's Total Proposal					

1. Each pay item should have a unit price and a total price.
2. If no total price is shown or if there is a discrepancy between the product of the unit price multiplied by the quantity, the unit price shall govern.
3. If a unit price is omitted, the total price will be divided by the quantity in order to establish a unit price.
4. A bid may be declared unacceptable if neither a unit price or total price is shown.

**VILLAGE OF HOFFMAN ESTATES  
SUMMARY OF QUANTITIES**

ITEM NO.	ITEM	UNIT	TOTAL QUANTITY
1	PRECONSTRUCTION VIDEO RECORDING	LSUM	1
2	ABANDON EXISTING WATER MAIN AND APPURTENANCES	LSUM	1
3	TRENCH BACKFILL - WATER MAIN	FOOT	84
4	DUCTILE IRON WATER MAIN, OPEN CUT, 16-INCH RJT	FOOT	109
5	CURED-IN-PLACE PIPE (WATER MAIN), 16-INCH	FOOT	1,801
6	CONNECTION TO WATER MAIN (NON-PRESSURE), 16-INCH	EACH	2
7	WATER VALVES, 16-INCH	EACH	2
8	VALVE VAULTS, 5-FOOT	EACH	1
9	VALVE VAULTS, 6-FOOT	EACH	1
10	FIRE HYDRANTS	EACH	1
11	FIRE HYDRANT BARREL EXTENSION	FOOT	8
12	EXPLORATION TRENCH (SPECIAL)	FOOT	100
13	PARKWAY RESTORATION	SQ YD	1,133
14	HOT-MIX ASPHALT SURFACE REMOVAL AND REPLACEMENT	SQ YD	12
15	AGGREGATE SURFACE COURSE REMOVAL AND REPLACEMENT, 8"	SQ YD	3,160
16	DUST CONTROL WATERING	UNIT	40
17	NON-SPECIAL WASTE DISPOSAL (IDOT ITEM 66900200)	CU YD	10

**VILLAGE OF HOFFMAN ESTATES  
SUMMARY OF QUANTITIES**

ITEM NO.	ITEM	UNIT	TOTAL QUANTITY
18	SOIL DISPOSAL ANALYSIS (IDOT ITEM 66900530)	EACH	1
19	REGULATED SUBSTANCES PRE-CONSTRUCTION PLAN (IDOT ITEM 66901001)	LSUM	1
20	REGULATED SUBSTANCES FINAL CONSTRUCTION REPORT (IDOT ITEM 66901003)	LSUM	1
21	REGULATED SUBSTANCES MONITORING (IDOT ITEM 66901006)	CAL DAY	5
22	FILTER ASSEMBLY SUPPLY AND INSTALLATION	EACH	3
23	PERIMETER EROSION BARRIER INSTALLATION AND MAINTENANCE	FOOT	2,100
24	TREE ROOT PRUNING	EACH	5
25	TREE PRUNING (1 TO 10 INCH DIAMETER)	EACH	2
26	TREE PRUNING (OVER 10 INCH DIAMETER)	EACH	2
27	TREE TRUNK PROTECTION	EACH	5
28	TEMPORARY FENCE	FOOT	45

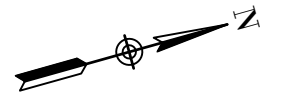
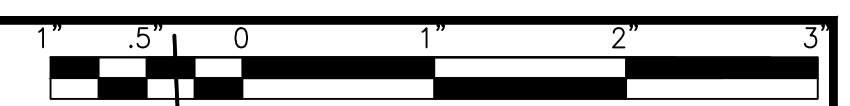

10 L.F. OF 16" RJT DI WATER MAIN (OPEN CUT)  
(2) 16" SLEEVES

41 L.F. OF CURED-IN-PLACE PIPE LINING

PROPOSED ACCESS PIT  
(RECOMMENDED LOCATION)  
CONTRACTOR TO COORDINATE  
WITH AT&T FOR ACCESS PIT  
LOCATION AND PROTECTION OF  
EXISTING UTILITIES

8" AGGREGATE BASE COURSE (CA-6)  
GEOTEXTILE STABILIZATION FABRIC - MIRAFI 500X OR EQUAL

10' PUBLIC UTILITY EASEMENT

REMOVED WATER VALVE VAULT  
10 L.F. OF 16" RJT DI WATER MAIN  
(2) 16" SLEEVES  
(1) 16" GATE VALVE IN 5' VAULT

PROPOSED ACCESS PIT  
(RECOMMENDED LOCATION)  
CONTRACTOR TO COORDINATE  
WITH AT&T AND COMED FOR  
ACCESS PIT LOCATION AND  
PROTECTION OF EXISTING  
UTILITIES

20 L.F. OF CURED-IN-PLACE  
PIPE LINING

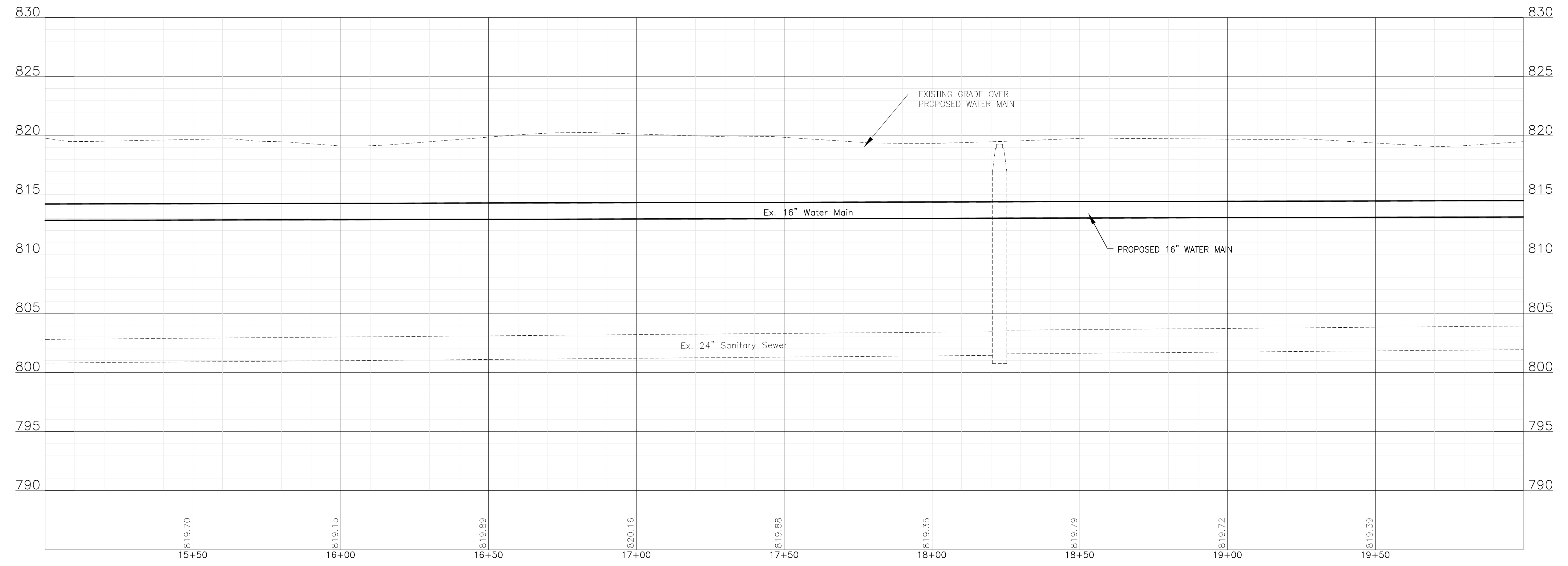
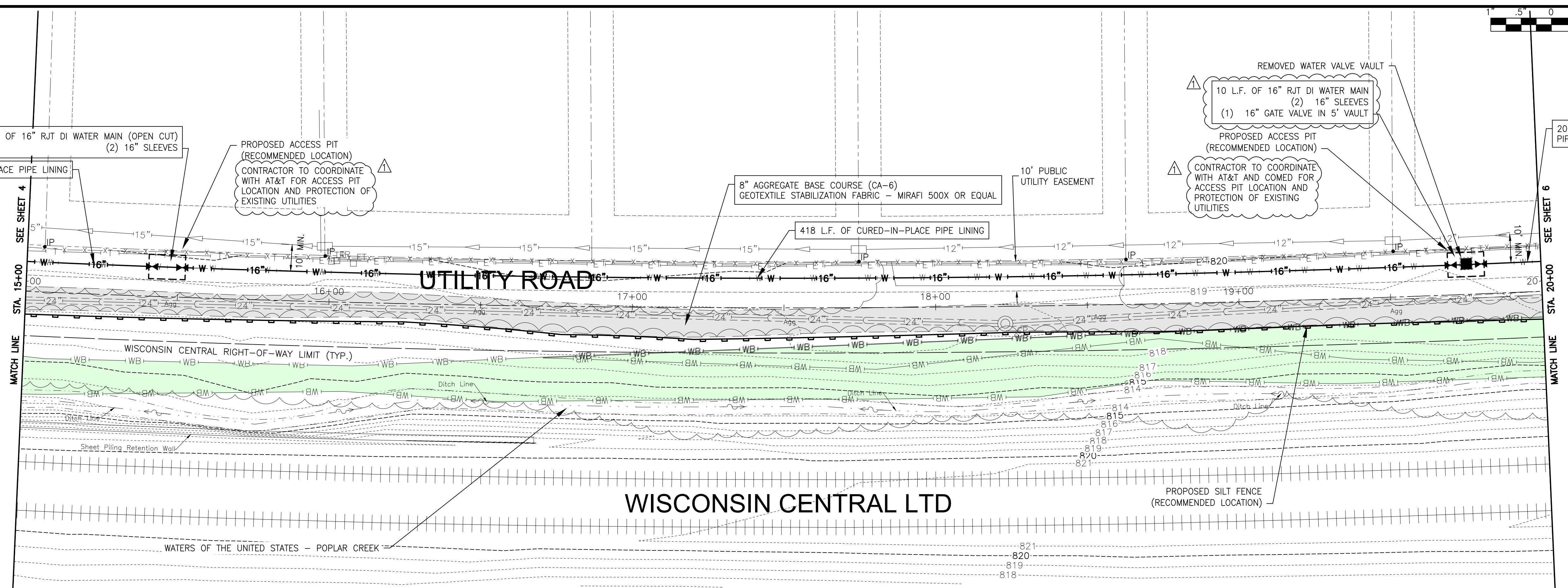

P:\OFFICE\2500360-SHOE FACTORY ROAD WATER MAIN REPLACEMENT\01\_CIVIL\_3D\01\_SHTS-PLANS\2500360-DESIGN SHEETS.DWG 15+00.00  
 Plotted: 7/1/2026 1:59 PM By: JWORSHAM  
 Copyright © 2026, By: Baxter & Woodman, Inc.  
 State of Illinois - Professional Design Firm  
 License No. - 184-001121 - Expires 4-30-27



CONSULTANTS	REVISED - $\Delta$ ADDENDUM #1 7/2/26
	REVISED -
	REVISED -
	REVISED -

**VILLAGE OF HOFFMAN ESTATES, ILLINOIS  
SHOE FACTORY ROAD WATER MAIN REHABILITATION**

**UTILITY ROAD STA. 15+00 TO STA 20+00 PLAN AND PROFILE**

SCALE: HORIZ 1"=20' / VERT 1"=5'

PROJECT NO: 2500360

DESIGNED - KPF	TOTAL SHEETS	SHEET NO.
DRAWN - ABN	10	5
CHECKED - WJW		
DATE - 6/24/2026		

FINAL DESIGN  
FOR BIDDING

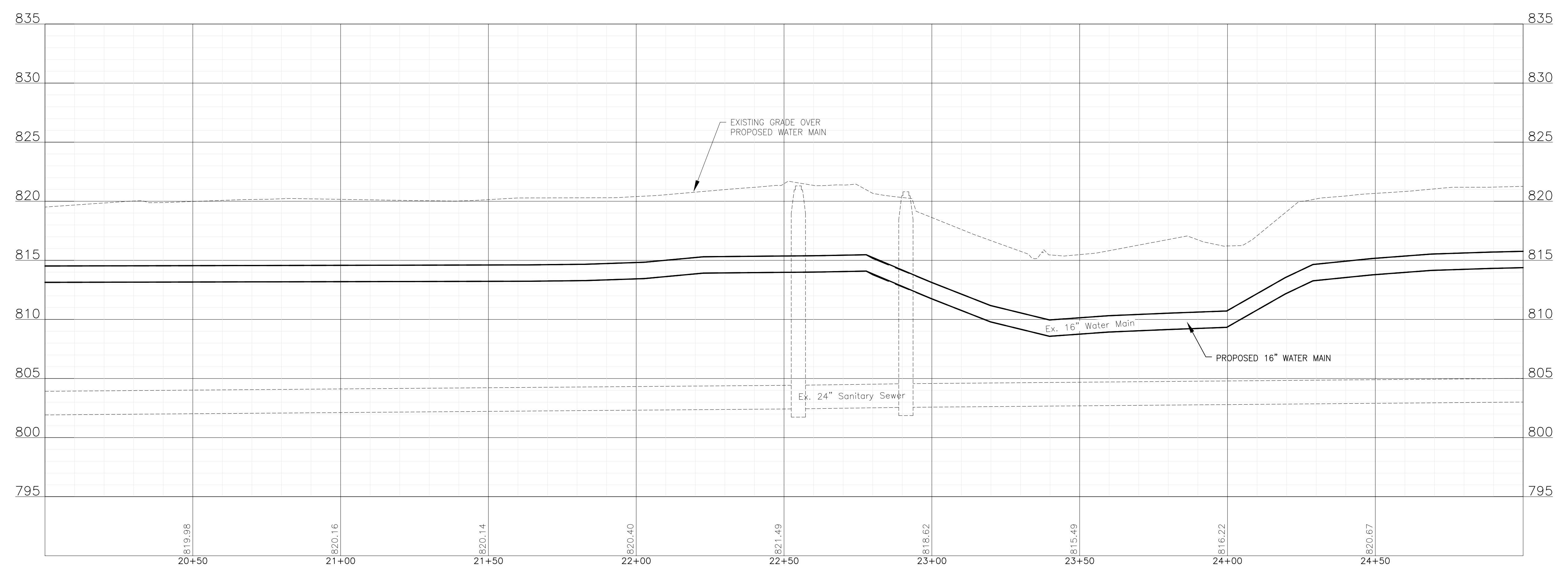
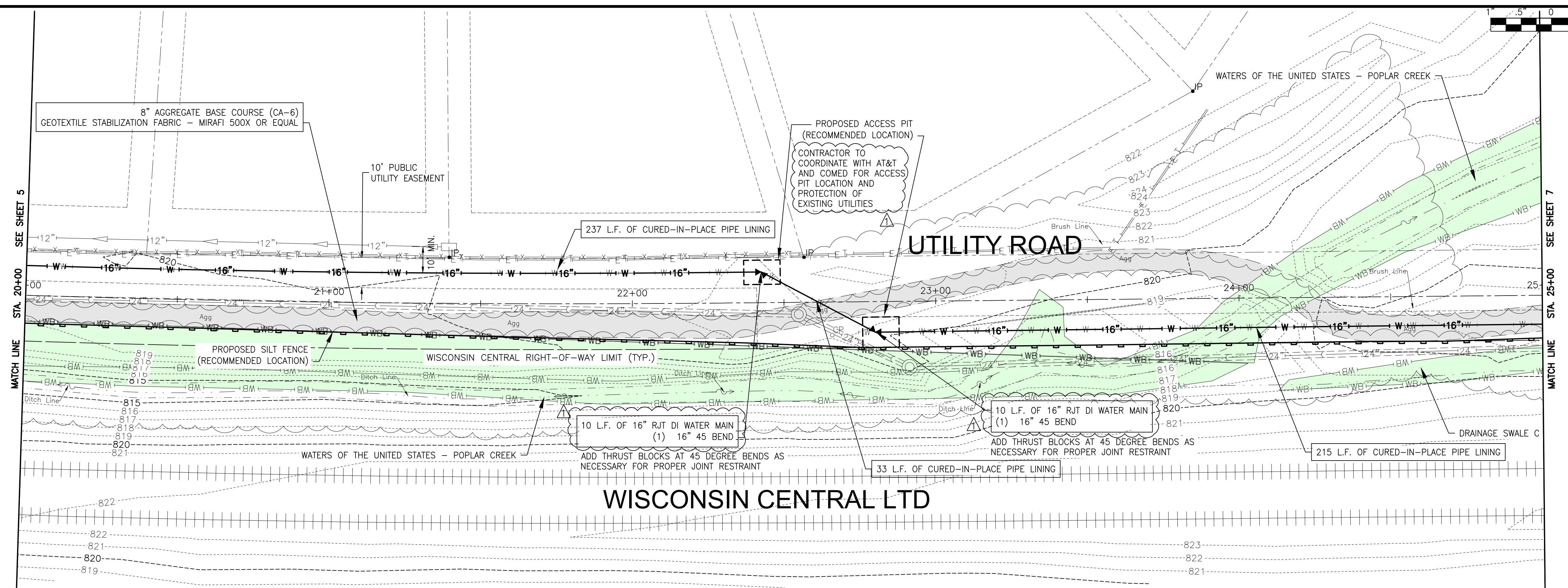

P:\OFFICE\2500360-SHOE FACTORY ROAD WATER MAIN REPLACEMENT\CAD\01\_CIVIL\_3D\01\_SHRITS-PLANS\2500360-DESIGN SHEETS.DWG 20+00.00  
 Plotted: 7/1/2026 2:00 PM By: JWORSHAM  
 Copyright © 2026, By: Baxter & Woodman, Inc.  
 State of Illinois - Professional Design Firm  
 License No. - 184-001121 - Expires 4-30-27



CONSULTANTS	REVISED - <input checked="" type="checkbox"/> ADDENDUM #1 7/2/26
	REVISED -
	REVISED -
	REVISED -

**VILLAGE OF HOFFMAN ESTATES, ILLINOIS**  
**SHOE FACTORY ROAD WATER MAIN REHABILITATION**

<b>UTILITY ROAD STA. 20+00 TO STA 25+00 PLAN AND PROFILE</b>		DESIGNED - KPF DRAWN - ABN CHECKED - WJW DATE - 6/24/2026	TOTAL SHEETS <b>10</b>	SHEET NO. <b>6</b>
SCALE:	HORIZ 1"=20' / VERT 1"=5'	PROJECT NO:	2500360	

**FINAL DESIGN**  
**FOR BIDDING**

P:\OFFICE\2500360-SHOE FACTORY ROAD WATER MAIN REPLACEMENT\01\_CIVIL\_3D\01\_SHRITS-PLANS\2500360-DESIGN SHEETS.DWG 25+00.00  
 Plotted: 7/1/2026 2:00 PM By: JWORSHAM  
 Copyright © 2026, By: Baxter & Woodman, Inc.  
 State of Illinois - Professional Design Firm  
 License No. - 184-001121 - Expires 4-30-27



CONSULTANTS	REVISED - ADDENDUM #1 7/2/2026
	REVISED -
	REVISED -
	REVISED -

**VILLAGE OF HOFFMAN ESTATES, ILLINOIS  
 SHOE FACTORY ROAD WATER MAIN REHABILITATION**

**UTILITY ROAD STA. 25+00 TO STA 29+97 PLAN AND PROFILE**

SCALE: HORIZ 1"=20' / VERT 1"=5'

PROJECT NO: 2500360

DESIGNED - KPF	TOTAL SHEETS	SHEET NO.
DRAWN - ABN	10	7
CHECKED - WJW		
DATE - 6/24/2026		

**FINAL DESIGN  
 FOR BIDDING**

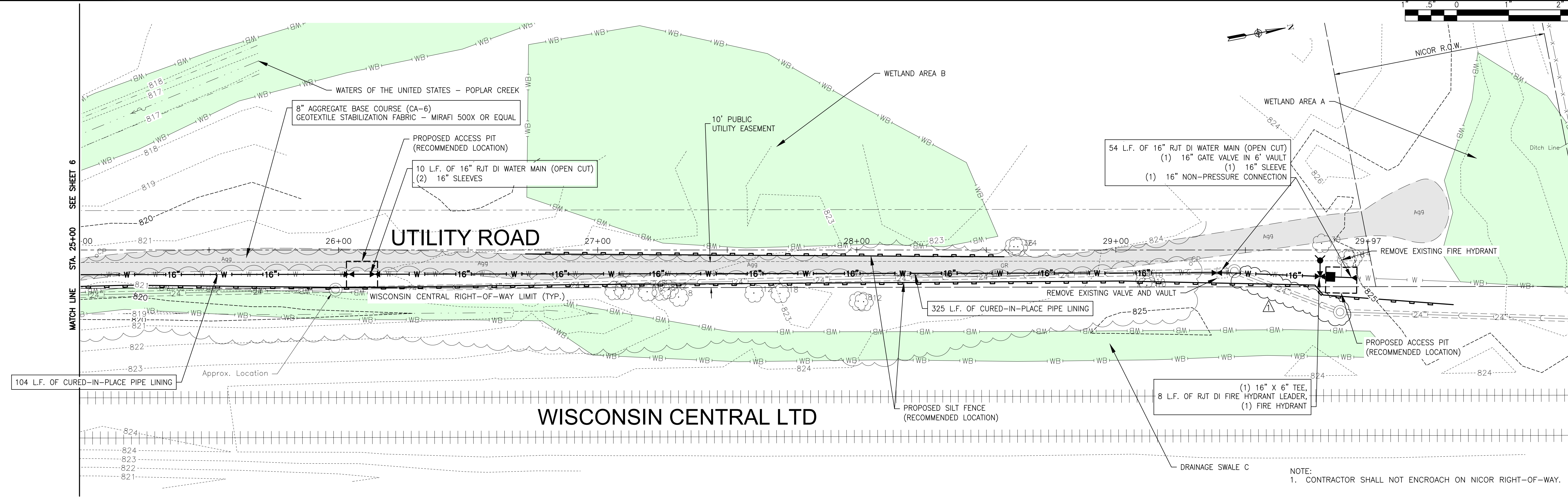
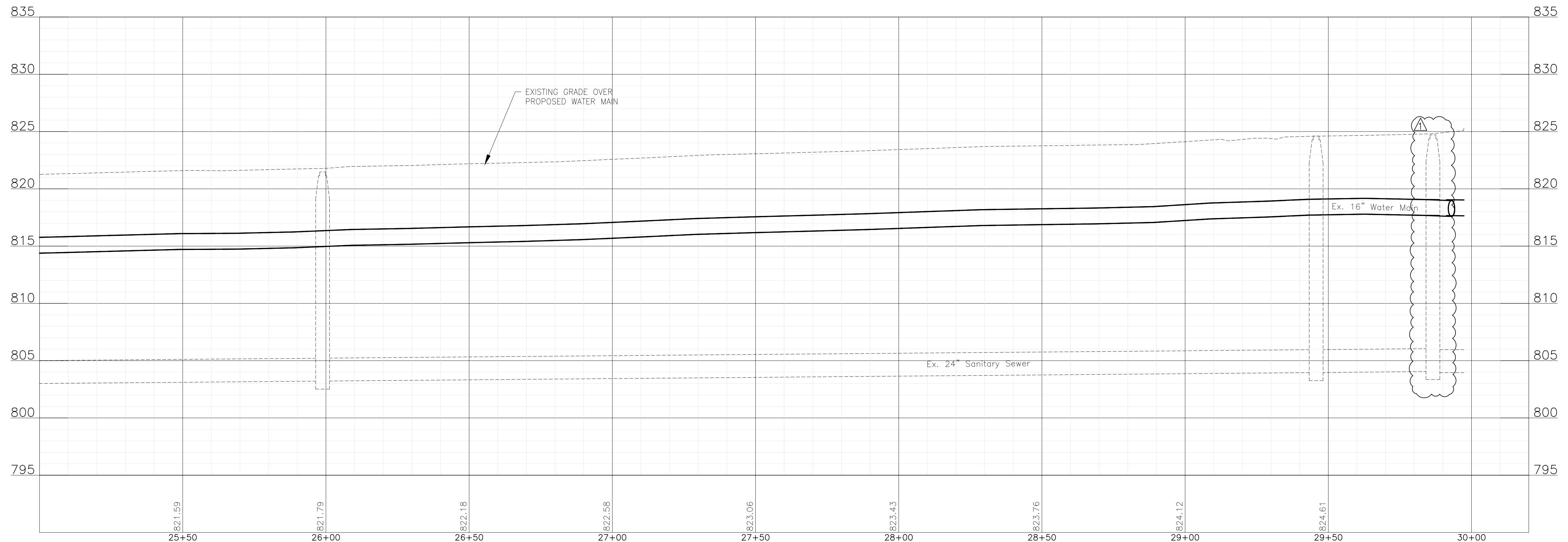

NOTE:  
 1. CONTRACTOR SHALL NOT ENCR OACH ON NICOR RIGHT-OF-WAY.